

Exploded View ID	RMI PART NUMBER	DESCRIPTION
1AL	RM-AT1AL	Tubular Belly Plate
2AL	RM-AT2AL	Tubular Belly Plate foam
3	RM-AT3	Single main tube RM-AT
4DC	RM-AT4DC	Dual Clamp 4 tubular BP
6AL	RM-AT6AL	Alum Shoulder w/out foam
7	RM-AT7	Shoulder foam RM-AT (Pair)
11	RM-AT11	End Cap for main tube RM-AT
12	RM-AT12	Stainless bolt & wshr - RM-AT
13	RM-AT13	Nylon locking Nut&Wshr - RM-AT
14DC	RM-AT14DC	SS Bolt/nut/wshr set in ziploc
15S	RM-AT15S	Shoulder clamp for snr/tnr
17	RM-AT17	Logo Plate tubular Rod RM-AT
18	RM-AT18	Bracket for Logo Plate RM-AT
19	RM-AT19	Stainless steel 3/4" bolt
20DC	RM-TROD6165	Drum Key bolt and wshr 4 dual
20	RM-TROD627	Drum Key Bolt and Wshr M6X27
21S	RM-AT21S	C JRod for Snare drums
BBC-Y	RM-BBC-Y	BB tubular coupler for - RM-AT
BBL-Y	RM-BBL-Y	Alum Backbar left wing
BBR-Y	RM-BBR-Y	Alum Backbar Right wing
MCCB	RM-MCCB	Comfort Core Cushion for BB
AP	RM-AP	Angle Dipped Plate - Pair

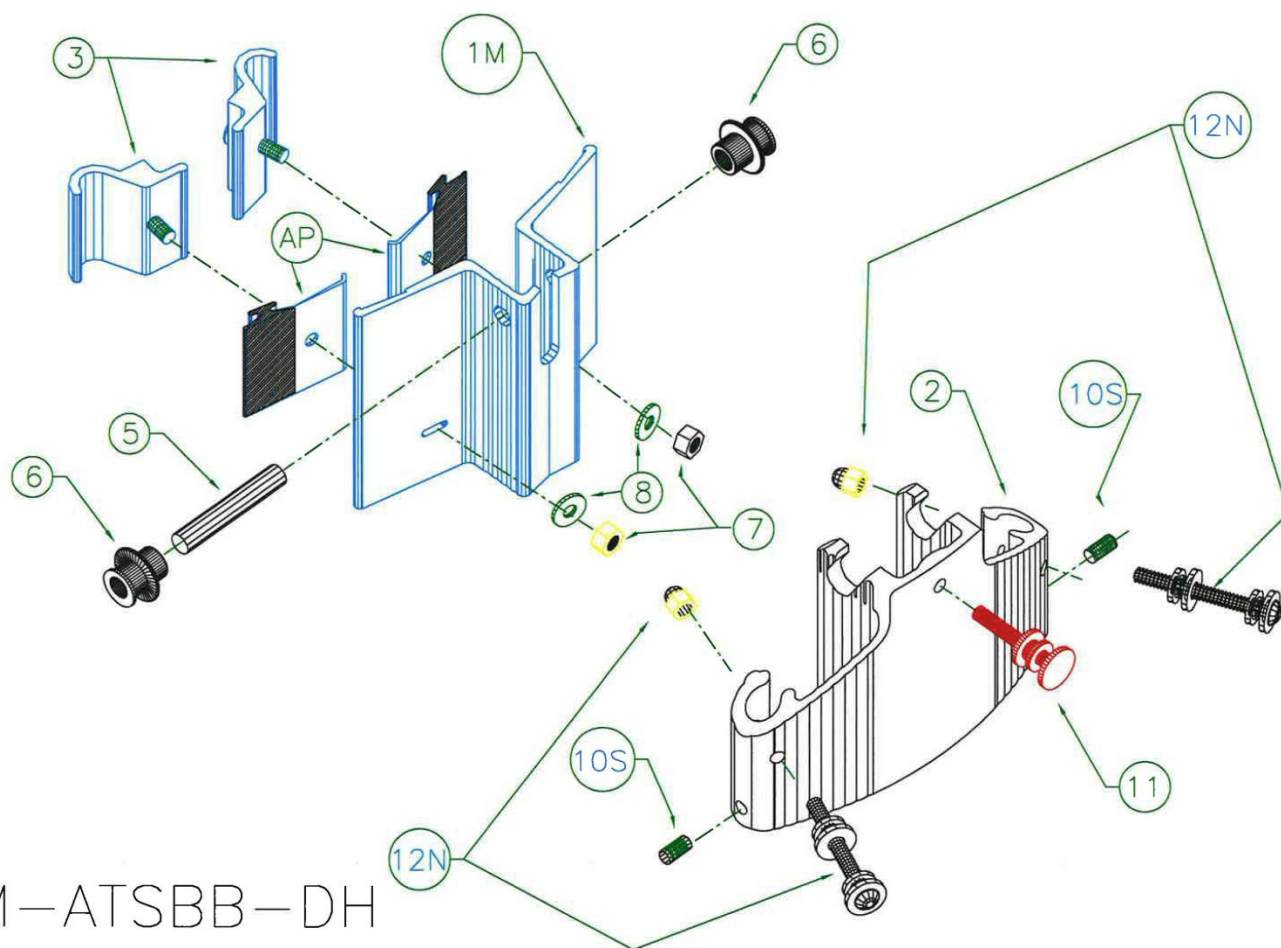

RM-ATSBB-DH

Exploded View ID	RMI PART NUMBER	DESCRIPTION
1M	RM-ATSBB-DH1M	Snare side hinge RM-AT/MS
2	RM-ATSBB-DH2	Carrier Side Hinge Only
3	RM-ATSBB-DH3	Tube Clamp for RM-ATS
5	RM-ATSBB-DH5	Hinge Axle for RM-ATS
6	RM-ATSBB-DH6	Hinge Axle bushing
7	RM-ATSBB-DH7	1/4-20 nylon nut
8	RM-ATSBB-DH8	1/4 SAE FLAT Washer Plated
10S	RM-ATSBB-DH10S	1/4-20 x 3/4 set screw
11	RM-ATSBB-DH11	Hinge Lock Bolt 1/4-20x1-1/2 with nut
12N	RM-ATSBB-DH12N	Bolt assy w/acorn nut