

RM-ATQBB

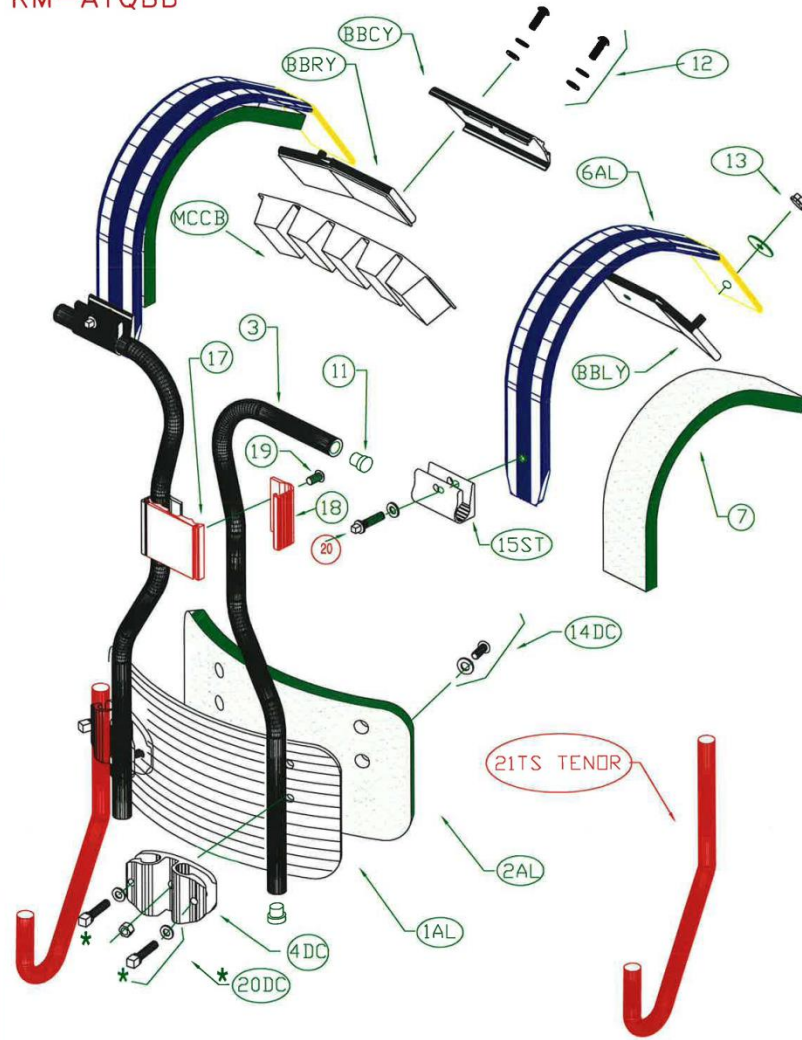

RMATQBB

RANDALL MAY INT'L.

Exploded View ID	RMI PART NUMBER	DESCRIPTION
1AL	RM-AT1AL	Tubular Belly Plate
2AL	RM-AT2AL	Tubular Belly Plate foam
3	RM-AT3	Single main tube RM-AT
4DC	RM-AT4DC	Dual Clamp 4 tubular BP
6AL	RM-AT6AL	Alum Shoulder w/out foam
7	RM-AT7	Shoulder foam RM-AT (Pair)
11	RM-AT11	End Cap for main tube RM-AT
12	RM-AT12	Stainless bolt & wshr - RM-AT
13	RM-AT13	Nylon locking Nut&Wshr - RM-AT
14DC	RM-AT14DC	SS Bolt/nut/wshr set in ziploc
15S	RM-AT15S	Shoulder clamp for snr/tnr
17	RM-AT17	Logo Plate tubular Rod RM-AT
18	RM-AT18	Bracket for Logo Plate RM-AT
19	RM-AT19	Stainless steel 3/4" bolt
20DC	RM-TROD6165	Drum Key bolt and wshr 4 dual
20	RM-TROD627	Drum Key Bolt and Wshr M6X27
21TS	RM-AT21TS	"TS" JRod for tenor drums
BBC-Y	RM-BBC-Y	BB tubular coupler for - RM-AT
BBL-Y	RM-BBL-Y	Alum Backbar left wing
BBR-Y	RM-BBR-Y	Alum Backbar Right wing
MCCB	RM-MCCB	Comfort Core Cushion for BB

RM-ATQBB-DH

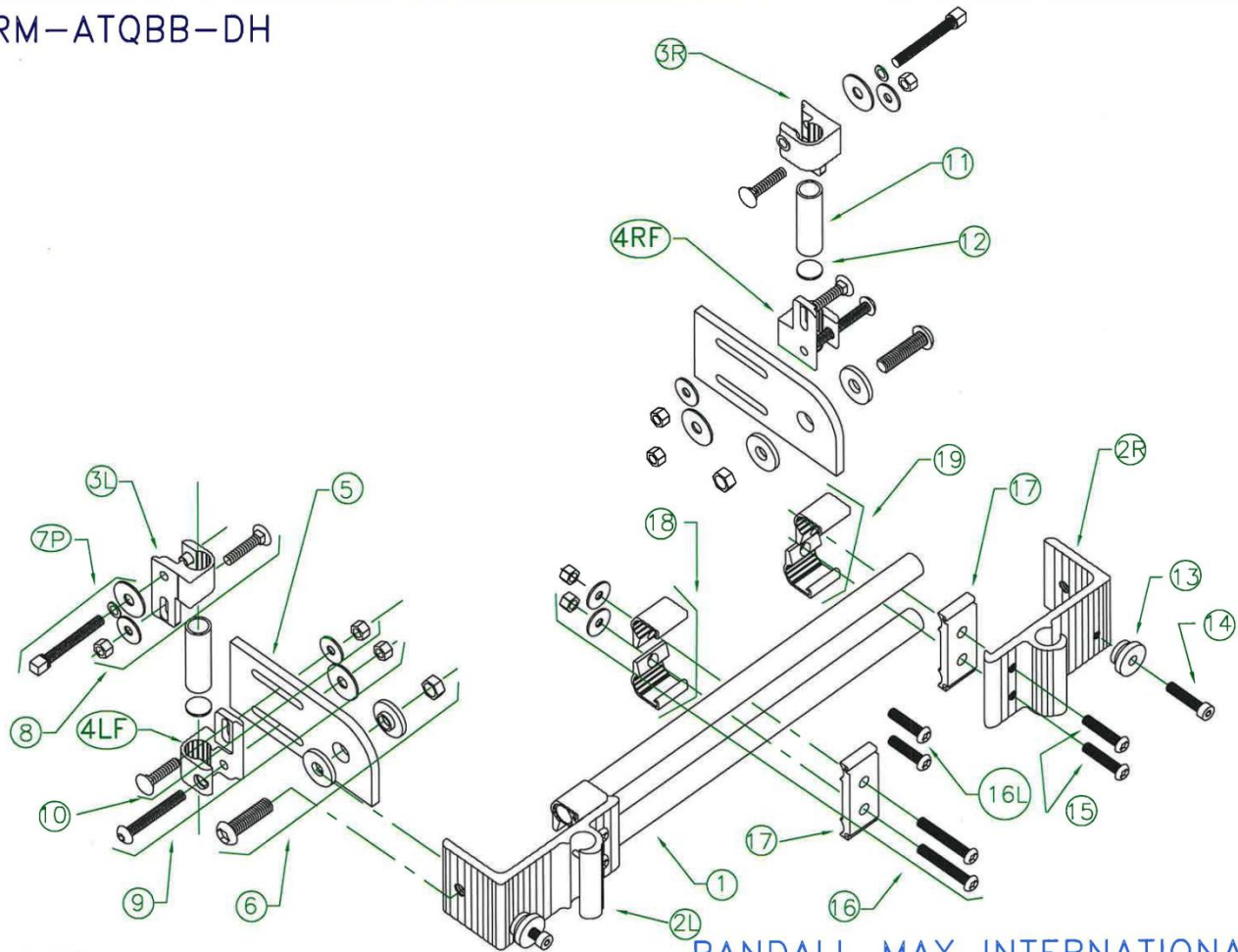

RMATQBBDH

RANDALL MAY INTERNATIONAL

Exploded View ID	RMI PART NUMBER	DESCRIPTION
1	RM-ATQBB-DH1	5/8 x 12.75 Tube rail
2L	RM-ATQBB-DH2L	Left tenor tube carrier arm w/pin
2R	RM-ATQBB-DH2R	Right tenor tube carrier arm w/pin
3L	RM-ATQBB-DH3L	N/A*
3R	RM-ATQBB-DH3R	N/A*
4LF	RM-ATQBB-DH4LF	N/A*
4RF	RM-ATQBB-DH4RF	N/A*
5	RM-ATQBB-DH5	Rotator Arm - Long (Standard)
6	RM-ATQBB-DH6	Bolt, wshr, shldr wshr & nut
7P	RM-ATQBB-DH7P	Keybolt and 2 washers
8	RM-ATQBB-DH8	Bolt, washer, and nut
9	RM-ATQBB-DH9	Bolt, Washer and Nut
10	RM-ATQBB-DH10	Bolt, washer, nut
11	RM-ATQBB-DH11	1-3/4 hinge tube w/plug
12	RM-ATQBB-DH12	tube cap
13	RM-ATQBB-DH13	Thumb Nut
14	RM-ATQBB-DH14	Socket Head Cap Screw
15	RM-ATQBB-DH15	1/4-20 x 1-1/4 screws and split washer
16	RM-ATQBB-DH16	1/4-20x1-1/4 bolts, nuts, washers 2ea
16L	RM-ATQBB-DH16L	Optional longer screws
17	RM-ATQBB-DH17	Anchor logo plate
18	RM-ATQBB-DH18	Anchor logo plate brackets ea
19	RM-ATQBB-DH19	Tenor Arm Anchor w/pemnut
	RM-ATQBB-DH-DA*	L/R Drm2Arm Pivot Tube MntBrkt, INC 3L, 3R, 4L, 4R, 7P, 8, 9, 10, 11, & 12)