

RM-ATBBB

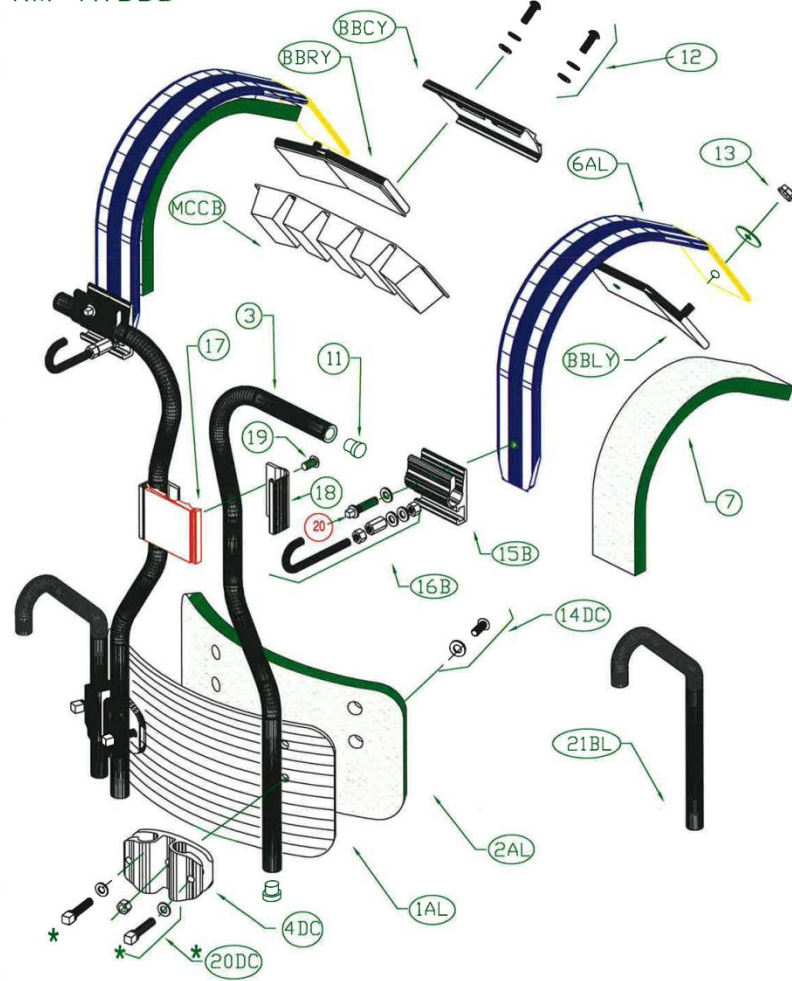

RMATBBB

RANDALL MAY INT'L.

Exploded View ID	RMI PART NUMBER	DESCRIPTION
1AL	RM-AT1AL	Tubular Belly Plate
2AL	RM-AT2AL	Tubular Belly Plate foam
AT	RM-AT3	Single main tube RM-AT
4DC	RM-AT4DC	Dual Clamp 4 tubular BP
6AL	RM-AT6AL	Alum Shoulder w/out foam
7	RM-AT7	Shoulder foam RM-AT (Pair)
11	RM-AT11	End Cap for main tube RM-AT
12	RM-AT12	Stainless bolt & wshr - RM-AT
13	RM-AT13	Nylon locking Nut&Wshr - RM-AT
14DC	RM-AT14DC	SS Bolt/nut/wshr set in ziploc
15B	RM-AT15B	Shoulder clamp for bass drum
16B	RM-AT16B	J-Bolt Assy (J-Bolt & n) RM-AT
17	RM-AT17	Logo Plate tubular Rod RM-AT
18	RM-AT18	Bracket for Logo Plate RM-AT
19	RM-AT19	Stainless steel 3/4" bolt
20DC	RM-TROD6165	Drum Key bolt and wshr 4 dual
20	RM-TROD627	Drum Key Bolt and Wshr M6X27
21B	RM-AT21B	"Y" J-Rod with Dip
BBC-Y	RM-BBC-Y	BB tubular coupler for - RM-AT
BBL-Y	RM-BBL-Y	Alum Backbar left wing
BBR-Y	RM-BBR-Y	Alum Backbar Right wing
MCCB	RM-MCCB	Comfort Core Cushion for BB